

OFI360-RW-048-U



Dual color type A/B medium intensity 48Vdc and FAA L-865/L-864 certified (Intertek)

P/N : 113792U

The obstafash system dual color or white only provides a day and night marking solution for all kind of obstacle higher than 45 meters. For obstacle below 150 meters the use of white or dual color flashing light medium intensity tye A during day time eliminate the need to paint the obstacle with red and white stripes)

Key Points

48VDC flashhead

- 6 led projectors in aluminium and glass
- 2 white led circuits in active redundancy inside each projector
- Simple installation with no losing parts when opening the flashhead
- 48VDC led drivers inside a stainless enclosure located in flashhead
- Alarm contact in case of lamp failure or 48V power supply failure
- Test button for day and night
- Luminous indicators for quick diagnostic
- 48Vdc surge protection with indicator showing when it has failed included



Patents: EP 1966535B1 & US 7816843

| Electrical Characteristics | | |
|----------------------------|--|--|
| Flashes per minute | | 40 or 20 |
| Power supply | | 48VDC -10%/+15% (max current 14A) |
| Average power consumption | | 55W (day time), 8W (night mode) |
| Mechanical Characteristics | | |
| Operating temperature | | -40/+55°C |
| Size of the light | | 333mm (height) x 500mm (diameter) |
| IP degree | | IP66 per projector |
| Weight | | 14kg for flashhead |
| Wiring | | Entry of cable by glands nickel plated brass and connection by terminals |
| Cable entry diameter | | 11 to 21mm |
| Wire cross section | | from 1 to 4 mm ² |
| Attachment | | 6 mounting holes dia.16mm, dia.337mm circle |

Mechanical Characteristics

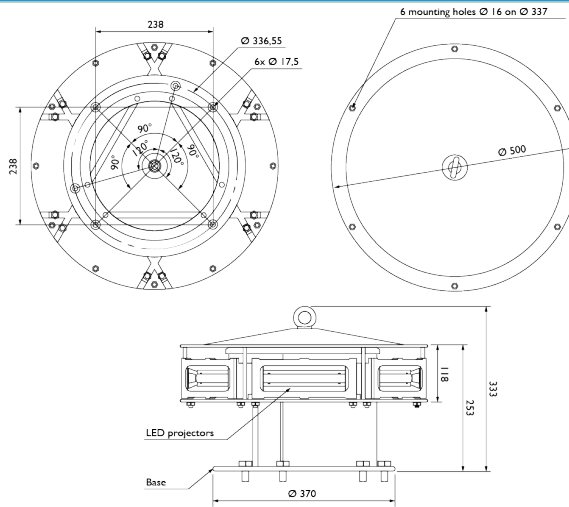

| Photometric Characteristics | | |
|--|--|---|
| Effective light output day time at 0° on site | | 20 000cd (white) |
| Effective light output twilight mode at 0° on site | | 20 000cd (white) |
| Effective light output night mode at 0° on site | | 2000cd (red) |
| Color day/twilight time | | white |
| Color night time | | Red |
| Vertical beam spread | | >3° |
| Horizontal beam spread | | 360° |
| Intensity @ -10% to the ground | | 3% of max |
| Flash per minute | | 40 (day time), 30 (night time) |
| Standards | | |
| Standards compliance | | ICAO annex 14 chapter 6, FAA (AC 150/5345-43H), EASA, DGAC, CAA |